

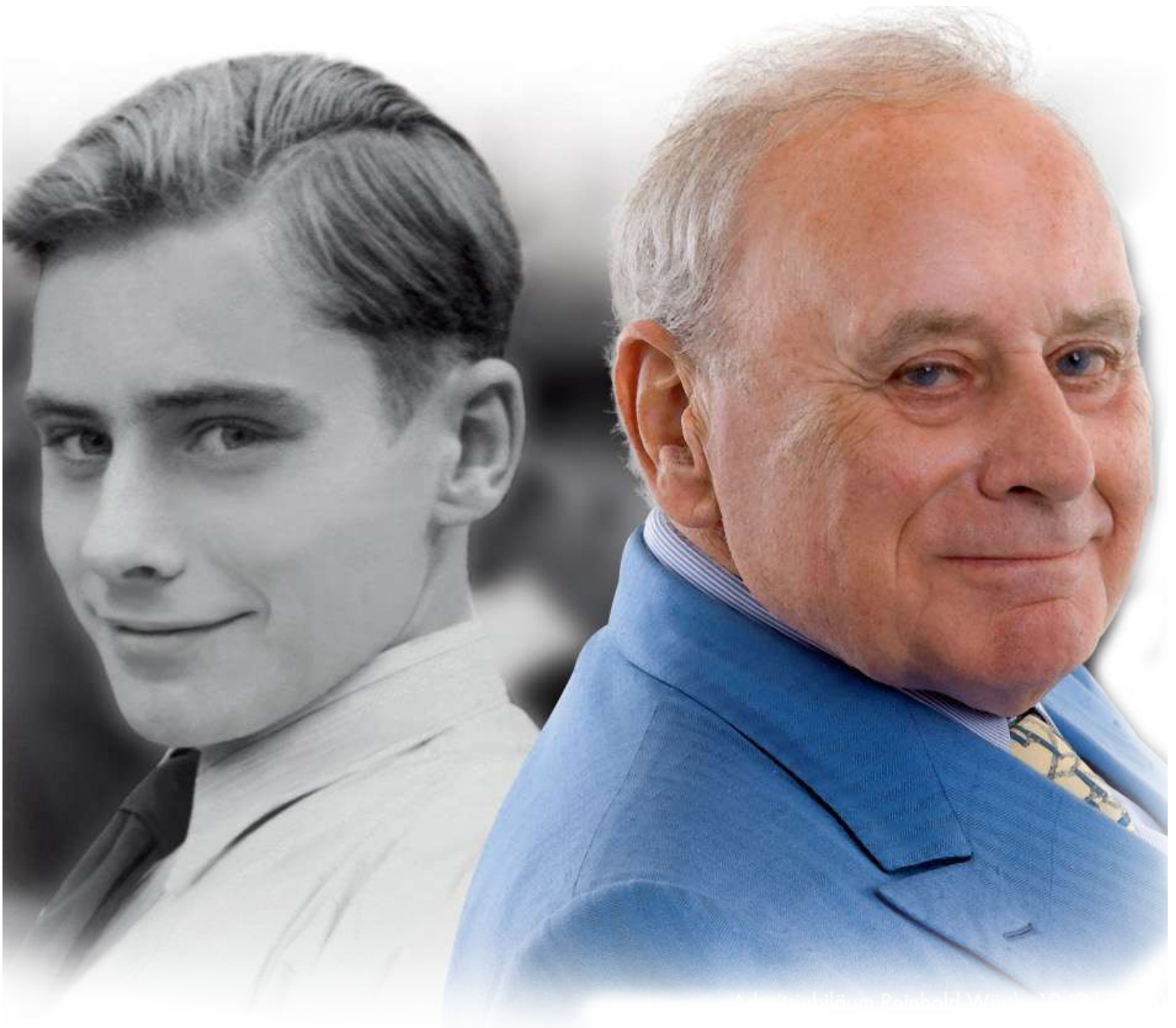

CATALOGUE

2024 - 2025





Adrian Würth, Reinhold Würth, 1960

WÜRTH IS QUALITY AND SERVICE

Würth is your specialist for assembly and fastening materials, technical chemicals, abrasives, and other material processing, workshop equipment, hand tools, power tools, auto electrical accessories, safety gear, and PPE. Würth has become the trusted supplier in the automotive, cargo, construction, mining, wood working and manufacturing industries.

The Würth Group is the global market leader in the development, production and sale of fastening and assembly materials. The family-owned company was founded in 1945 in Künzelsau, Germany and holds over 3.8 million customers worldwide that trust in Würth today.

Our goal lies in simplifying our customers' daily work. We excel as problem-solvers with unique and innovative products and services through a range of Sale Channels tailored to the customers' needs and location.

We ensure accessibility and excellence through:

Our Multi -Channel Strategy:

1. Direct sales consultants in the field
2. Convenient pickup shops
3. Comprehensive online shop

Our online platform provides detailed product information, certificates. and technical data sheets for customer convenience.

WHY CHOOSE WÜRTH KENYA LTD?

GERMAN QUALITY:

Each Würth product is fit-for purpose, top quality, durable and reliable, and has been subjected to tougher testing by us than it will ever face in real applications.

GLOBAL REACH:

As part of the Würth Group, comprising over 400 companies and 87,000 employees in 80+ countries, we leverage a vast international network to serve you better.

EXTENSIVE PRODUCT RANGE:

With over 125,000 products ranging from hand tools to automotive consumables, we've got you covered across various industries.

"The culture of the Würth Group is marked by mutual trust, reliability, honesty and righteousness, inside and outside the company."



INSPIRED BY YOU.

MADE BY WÜRTH.



**POWER +
HAND TOOLS**

**#READY
FOR WORK**

POWER + HAND TOOLS

HAND TOOLS



STEEL MEASURING RULER MADE OF STAINLESS, FLEXIBLE STEEL

ART.-NO. 0695072500

APPLICATION

- Allows simple, precise reading

VARIANTS

Art.-no.	Length of tape	Width of band	Thickness of tape	Scale marking on top edge (length)
0695072300	300 mm	13 mm	0.5 mm	0.5 mm
0695072500	500 mm	18 mm	0.5 mm	0.5 mm



TYRE IRON

ART.-NO. 0695326809

APPLICATION

- Special curved shape for commercial vehicles



METAL WORKSHOP OILER

ART.-NO. 0695555402

APPLICATION

- Ergonomic zinc diecast oil container



PAINTERS' SPATULA MADE OF FLEXIBLE, HIGH-QUALITY STEEL (TAPER GROUND)

ART.-NO. 0695940905

APPLICATION

- For removing bumps and wallpaper or adhesive residues
- For removing old paint, flash rust, wall coverings



CABLE KNIFE

ART.-NO. 069594109

APPLICATION

- Folding cable knife with black, impact-resistant plastic handle



NUMBER PUNCHES

ART.-NO. 069594161

VARIANTS

Art.-no.	Character height
0695941618	8 mm
069594161	10 mm



BERN-TYPE PLASTERING TROWEL, WELDED

ART.-NO. 0695943130

APPLICATION

- High-quality trowel with welded blade



UNIVERSAL THREAD FILE FOR METRIC THREAD ISO

ART.-NO. 071461 77

APPLICATION

- For internal and external threads

POWER + HAND TOOLS

HAND TOOLS



INDUSTRIAL HAND BRUSH ARENGA/ELASTON FOR COARSE AND FINE DIRT OUTDOORS

ART.-NO. 0695944415

APPLICATION

- For coarse and fine outdoor dirt.

VARIANTS

Art.-no.	Length of tape	Width of band	Thickness of tape	Scale marking on top edge (length)
0695072300	300 mm	13 mm	0.5 mm	0.5 mm
0695072500	500 mm	18 mm	0.5 mm	0.5 mm



WIRE BRUSH WITH WOODEN BODY

ART.-NO. 06974

APPLICATION

- Wire brush

VARIANTS

Art.-no.	Number of rows	Width	Material of wire	Wire diameter
06974	4 PCS	33 mm	Steel	0.35 mm
06976	6 PCS	43 mm	Steel	0.35 mm



1/2-INCH T-HANDLE

ART.-NO. 0712130201

APPLICATION

- Sliding handle with ball lock can be used as a T or an L-handle.



1/2 INCH SOCKET WRENCH INSERT METRIC, HEXAGON, SHORT

ART.-NO. 0712131108

NOTICE

- Suitable for manual use in DIN 3120 reversible ratchets

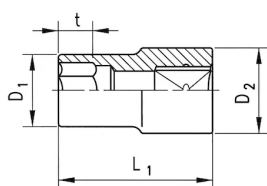

VARIANTS

Art.-no.	Width across flats	Length	Socket wrench external diameter	Socket wrench external diameter 2
0712131108	8 mm	36 mm	13 mm	23 mm
0712131110	10 mm	36 mm	15.5 mm	23 mm
0712131111	11 mm	36 mm	16.7 mm	23 mm
0712131112	12 mm	36 mm	18 mm	23 mm
0712131113	13 mm	36 mm	19.2 mm	23 mm
0712131114	14 mm	36 mm	20.5 mm	23 mm
0712131115	15 mm	36 mm	21.7 mm	22 mm
0712131116	16 mm	36 mm	23 mm	23.2 mm
0712131117	17 mm	36 mm	24.2 mm	23.2 mm
0712131118	18 mm	36 mm	25.5 mm	23.5 mm
0712131119	19 mm	36 mm	26.7 mm	24.7 mm
0712131120	20 mm	36 mm	28 mm	25.5 mm
0712131121	21 mm	38 mm	29.2 mm	26 mm
0712131122	22 mm	38 mm	30.5 mm	26.5 mm
0712131124	24 mm	38 mm	33 mm	29 mm
0712131125	25 mm	38 mm	34 mm	30 mm
0712131126	26 mm	38 mm	35.5 mm	31.5 mm
0712131127	27 mm	44 mm	36.7 mm	32.2 mm
0712131130	30 mm	44 mm	40.5 mm	36 mm
0712131132	32 mm	44 mm	43 mm	38.1 mm
0712131134	34 mm	47 mm	45.5 mm	40 mm
0712131136	36 mm	50 mm	48 mm	42 mm



1/2 INCH CARDAN JOINT

ART.-NO. 0712138301

APPLICATION

- Standard: DIN 3123, ISO 3316
- Surface: Chrome-plated
- Drive: 1/2 inch square drive, ball catch groove
- Output: 1/2 inch square drive

QUALITY WITH OUR HAND TOOLS

POWER + HAND TOOLS

HAND TOOLS



1/2" CONNECTION

ART.-NO. 0712138401

APPLICATION

- Adapter for socket wrench inserts



SHEET METAL SNIPS

ART.-NO. 071303 200

APPLICATION

- Right-cutting snips = metal support on right, preferably for right-hand curves



LOCKING PLIERS

ART.-NO. 071309 10

APPLICATION

- With straight jaws
- Smooth-action release lever with spring mechanism
- One-hand operation – pulling instead of pushing
- Jam nut for locking the clamping width, consistent adjustment during repetitive operations



CLAMPING GRIP PLIERS, C TYPE, PARALLEL 165MM

ART.-NO. 071309 22

APPLICATION

- Suitable for clamping and securing components with especially high surface pressure

VARIANTS

Art.-no.	Length	Min./max. clamping width	Clamping depth	Height
071309 22	165 mm	0-50 mm	46 mm	60 mm
071509 22	180 mm	0-42 mm	35 mm	58 mm



1/4 INCH MULTI-SOCKET WRENCH SET 12 PIECES

ART.-NO. 07131130

APPLICATION

- One socket for five different screw heads



1/4" MULTI-SOCKET WRENCH INSERT BI-HEX, MULTI PROFILE

ART.-NO. 071311305

APPLICATION

- For the five most common screw head drives

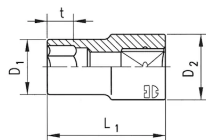

VARIANTS

Art.-no.	Width across flats	Socket wrench external diameter	Socket wrench external diameter 2	Socket wrench depth
071311305	5 mm	8.1 mm	11.9 mm	5 mm
071311306	6 mm	9.3 mm	11.9 mm	6 mm
071311307	7 mm	10.8 mm	11.9 mm	6 mm
071311308	8 mm	11.9 mm	11.9 mm	7 mm
071311310	10 mm	14.5 mm	14.5 mm	10 mm
071311311	11 mm	15.9 mm	15.9 mm	10 mm
071311312	12 mm	16.9 mm	16.9 mm	10 mm
071311313	13 mm	18 mm	18 mm	11 mm
071311314	14 mm	19.6 mm	19.6 mm	11 mm



3/8-INCH SOCKET WRENCH INSERT, METRIC LONG

ART.-NO. 0713122120

APPLICATION

- Screw connections on studs and threaded rods

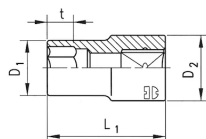

VARIANTS

Art.-no.	Width across flats	Socket wrench external diameter	Socket wrench depth	Socket wrench external diameter 2
0713122107	7 mm	10.9 mm	13 mm	16.7 mm
0713122108	8 mm	11.8 mm	15 mm	16.7 mm
0713122109	9 mm	13.4 mm	16 mm	16.7 mm
0713122114	14 mm	19.5 mm	25.5 mm	19.5 mm
0713122115	15 mm	20.7 mm	25.5 mm	20.7 mm
0713122118	18 mm	23.8 mm	25.5 mm	23.8 mm
0713122120	20 mm	27.1 mm	25.5 mm	25.5 mm
0713122122	22 mm	29.6 mm	25.5 mm	27 mm

POWER + HAND TOOLS

HAND TOOLS



3/8 INCH MULTI-PROFILE SOCKET WRENCH SET 13 PIECES

ART.-NO. 07131230

APPLICATION

- One socket for five different screw heads



3/8" SOCKET WRENCH BI- HEX, MULTI PROFILE

ART.-NO. 071312312

APPLICATION

- For the five most common screw head drives

VARIANTS

Art.-no.	Width across flats	Length	Socket wrench external diameter	Socket wrench depth
071312312	12 mm	25.5 mm	17 mm	8.5 mm
071312314	14 mm	27 mm	19.6 mm	13 mm



METRIC COMBINATION WRENCH WITH POWERDRIV®

ART.-NO. 071330107

APPLICATION

- Robust wrench with box and open ends

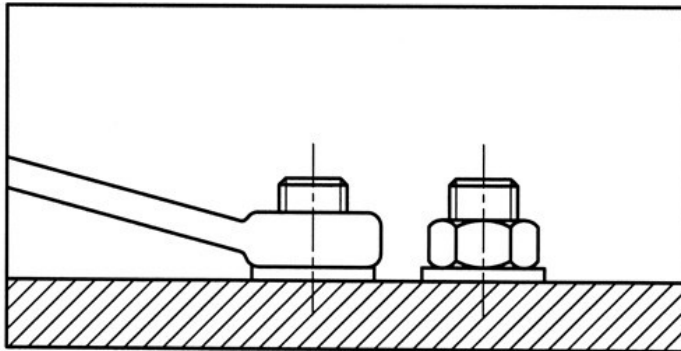

VARIANTS

Art.-no.	Width across flats	Length	Ring thickness	Thickness of jaw
071330106	6 mm	100 mm	5.5 mm	3.7 mm
071330107	7 mm	110 mm	6 mm	4 mm
071330108	8 mm	120 mm	6 mm	4 mm
071330109	9 mm	130 mm	7 mm	4 mm
071330110	10 mm	140 mm	7.5 mm	4.5 mm
071330111	11 mm	150 mm	8 mm	5 mm
071330112	12 mm	160 mm	8.5 mm	5.5 mm
071330113	13 mm	170 mm	9 mm	5.5 mm
071330114	14 mm	180 mm	9.5 mm	6 mm
071330115	15 mm	190 mm	10 mm	6 mm
071330116	16 mm	200 mm	10 mm	6 mm
071330117	17 mm	205 mm	10.5 mm	6.5 mm
071330118	18 mm	215 mm	11 mm	7 mm
071330119	19 mm	230 mm	11.5 mm	7.5 mm
071330120	20 mm	240 mm	12 mm	8 mm
071330121	21 mm	250 mm	12.5 mm	8 mm
071330122	22 mm	260 mm	13.5 mm	8 mm
071330123	23 mm	270 mm	14 mm	8 mm
071330124	24 mm	280 mm	14.5 mm	9 mm
071330125	25 mm	290 mm	15 mm	9 mm
071330126	26 mm	300 mm	15.5 mm	9 mm
071330127	27 mm	310 mm	15.5 mm	9 mm
071330128	28 mm	320 mm	16 mm	9 mm
071330130	30 mm	340 mm	17 mm	10 mm
071330132	32 mm	350 mm	17.5 mm	11 mm
071330134	34 mm	360 mm	18 mm	12 mm



COMBINATION WRENCH ASSORTMENT, SHORT TYPE

ART.-NO. 071330141

APPLICATION

- Ring end POWERDRIV®, bi-hexagonal

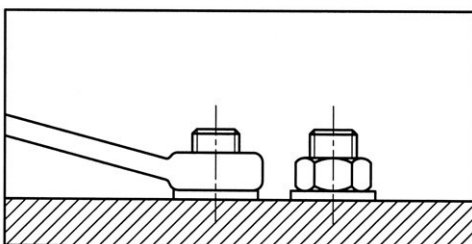

VARIANTS

Art.-no.	Number of pieces in assortment/set	Width across flats
071330142	28 PCS	5.5 mm, 6 mm, 7 mm, 8 mm, 9 mm, 10 mm, 11 mm, 12 mm, 13 mm, 14 mm, 15 mm, 16 mm, 17 mm, 18 mm, 19 mm, 20 mm, 21 mm, 22 mm, 23 mm, 24 mm, 25 mm, 26 mm, 27 mm, 28 mm, 29 mm, 30 mm, 32 mm, 34 mm
071330141	17 PCS	6 mm, 7 mm, 8 mm, 9 mm, 10 mm, 11 mm, 12 mm, 13 mm, 14 mm, 15 mm, 16 mm, 17 mm, 18 mm, 19 mm, 20 mm, 21 mm, 22 mm

POWER + HAND TOOLS

HAND TOOLS



METRIC COMBINATION WRENCH WITH POWERDRIV®

ART.-NO. 071330236

APPLICATION

- Robust wrench with box and open ends

VARIANTS

Art.-no.	Width across flats	Length	Ring thickness	Thickness of jaw
071330236	36 mm	458 mm	19.60 mm	12.70 mm
071330241	41 mm	518 mm	22 mm	14.30 mm
071330246	46 mm	580 mm	23.80 mm	15.60 mm



COMBINATION WRENCH, INCH WITH POWERDRIV®

ART.-NO. 071330303

APPLICATION

- Robust, short wrench with box and open ends

VARIANTS

Art.-no.	Width across flats	Length	Ring thickness	Thickness of jaw
071330303	3/8 inch	140 mm	7.5 mm	4.5 mm
071330306	9/16 inch	180 mm	9.5 mm	6 mm



VDE SIDE CUTTERS, DIN ISO 5749 IEC 60900

ART.-NO. 071401 572

APPLICATION

- For cutting hard and soft wires and cables, including in hard-to-reach places

VARIANTS

Art.-no.	Length	Max. medium wire diameter cutting capacity	Max. hard wire diameter cutting capacity	Max. soft wire diameter cutting capacity
071401 572	160 mm	2.8 mm	2 mm	4 mm
071401 573	180 mm	3 mm	2.5 mm	4 mm



VDE COMBINATION PLIERS DIN ISO 5746, IEC 60900

ART.-NO. 071401 575

APPLICATION

- For gripping, holding and cutting hard and soft wires and cables



VDE SNIPE NOSE PLIERS DIN ISO 5745, IEC 60900

ART.-NO. 071401 577

APPLICATION

- For gripping, holding and cutting soft and hard wires and cables



VDE CABLE CUTTERS WITH SINGLE BLADE

ART.-NO. 071401 585

APPLICATION

- For cutting copper and aluminium cable



VDE HEAVY-DUTY SIDE CUTTERS DIN ISO 5749, IEC 60900

ART.-NO. 071401 597

APPLICATION

- For cutting piano wire, hard and soft wire



CIRCLIP PLIERS, SHAPE C FOR BORE CIRCLIPS

ART.-NO. 071402 02

APPLICATION

- Circlip pliers for inner rings.

VARIANTS

Art.-no.	Length	Min./max. grip range	Jaws length	Diameter of tenon
071402 02	140 mm	12-25 mm	38 mm	1.25 mm
071402 03	180 mm	19-60 mm	54 mm	1.8 mm
071402 04	225 mm	40-100 mm	65 mm	2.25 mm
071402 05	320 mm	85-140 mm	91 mm	3.2 mm

POWER + HAND TOOLS

HAND TOOLS



1/2-INCH IMPACT SOCKET WRENCH INSERT HEXAGON, METRIC, LONG

ART.-NO. 071413 17

APPLICATION

- Fits all conventional pneumatic and electric drivers

VARIANTS

Art.-no.	Width across flats	Length	Ring thickness	Thickness of jaw
071330236	36 mm	458 mm	19.60 mm	12.70 mm
071330241	41 mm	518 mm	22 mm	14.30 mm
071330246	46 mm	580 mm	23.80 mm	15.60 mm



1/2 INCH POWER EXTENSION WITH 1/2 INCH SQUARE DRIVE AND BALL LOCK

ART.-NO. 071413 22

APPLICATION

- Suitable for all standard compressed air and electric screwdrivers



1/2" POWER CONNECTOR WITH 3/4 INCH SQUARE DRIVE AND BALL LOCK

ART.-NO. 071413 28

APPLICATION

- Suitable for all standard compressed air and electric screwdrivers



1/2 INCH IMPACT SOCKET WRENCH INSERT HEXAGON, METRIC, SHORT

ART.-NO. 071413 36

APPLICATION

- Fits all conventional pneumatic and electric drivers

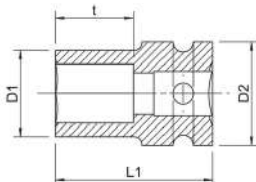

VARIANTS

Art.-no.	Width across flats	Length	Socket wrench external diameter	Socket wrench external diameter 2
071413 03	10 mm	38 mm	17 mm	25 mm
071413 05	13 mm	38 mm	21 mm	25 mm
071413 06	14 mm	38 mm	22.5 mm	25 mm
071413 07	15 mm	38 mm	23 mm	30 mm
071413 071	16 mm	38 mm	25 mm	30 mm
071413 08	17 mm	38 mm	26 mm	30 mm
071413 081	18 mm	38 mm	27.3 mm	30 mm
071413 09	19 mm	38 mm	28.5 mm	30 mm
071413 091	21 mm	38 mm	30 mm	30 mm
071413 10	22 mm	38 mm	32 mm	30 mm
071413 11	24 mm	38 mm	34 mm	30 mm
071413 36	36 mm	48 mm	49 mm	30 mm



UNIVERSAL SOCKET FOR SIZE 13 TO 32

ART.-NO. 0714131907

APPLICATION

- For loosening and tightening screws and nuts



1/2-INCH IMPACT SOCKET WRENCH INSERT BI-HEX, METRIC, SHORT

ART.-NO. 0714131913

APPLICATION

- Fits all conventional pneumatic and electric drivers



1/2-INCH IMPACT SOCKET WRENCH INSERT BI-HEX, METRIC, SHORT

ART.-NO. 0714131913

APPLICATION

- Fits all conventional pneumatic and electric drivers

VARIANTS

Art.-no.	Width across flats	Length	Socket wrench external diameter	Socket wrench external diameter 2
0714131913	13 mm	20.5 mm	24 mm	10 mm
0714131917	17 mm	26 mm	26 mm	12 mm
0714131919	19 mm	28 mm	28 mm	14 mm
0714131921	21 mm	30 mm	30 mm	14 mm

POWER + HAND TOOLS

HAND TOOLS



3/4 INCH CONNECTOR WITH 1 INCH SQUARE DRIVE AND BALL LOCKING MECHANISM

ART.-NO. 071414 19

APPLICATION

- Fits all conventional compressed air and electric drivers

VARIANTS

Art.-no.	Tip size	Length	Drive	Socket wrench external diameter
071414 19	1 inch	63 mm	3/4 inch	44 mm
071414 191	1/2 inch	58 mm	3/4 inch	44 mm



3/4-INCH IMPACT SOCKET WRENCH INSERT HEXAGON, METRIC, LONG

ART.-NO. 071414 46

APPLICATION

- Fits all conventional compressed air and electric drivers

VARIANTS

Art.-no.	Width across flats	Socket wrench external diameter	Socket wrench depth	Drive
071414 09	17 mm	29 mm	13 mm	3/4 inch
071414 091	18 mm	30 mm	13 mm	3/4 inch
071414 10	19 mm	32 mm	15 mm	3/4 inch
071414 101	21 mm	35 mm	15 mm	3/4 inch
071414 11	22 mm	36 mm	15 mm	3/4 inch
071414 12	24 mm	39 mm	16 mm	3/4 inch
071414 13	27 mm	42 mm	16 mm	3/4 inch
071414 14	30 mm	46 mm	16 mm	3/4 inch
071414 15	32 mm	48 mm	18 mm	3/4 inch
071414 151	33 mm	50 mm	20 mm	3/4 inch
071414 16	36 mm	54 mm	20 mm	3/4 inch
071414 46	46 mm	66 mm	24 mm	3/4 inch

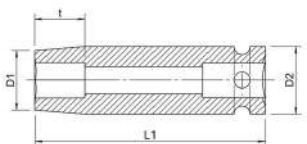

3/4-INCH IMPACT SOCKET WRENCH INSERT FOR HEXAGON SOCKET SCREWS, METRIC, LONG

ART.-NO. 071414 517

APPLICATION

- Fits all conventional compressed air and electric drivers

VARIANTS

Art.-no.	Width across flats	Drive	Length	Blade length
071414 517	17 mm	3/4 inch	100 mm	22 mm
071414 519	19 mm	3/4 inch	100 mm	22 mm



1-INCH IMPACT SOCKET WRENCH INSERT HEXAGON, METRIC, SHORT

ART.-NO. 071415 46

APPLICATION

- Fits all conventional compressed air and electric drivers

VARIANTS

Art.-no.	Width across flats	Length	Socket wrench external diameter	Socket wrench depth
071415 46	46 mm	72 mm	68 mm	24 mm
071415 50	50 mm	75 mm	74 mm	26 mm
071415 55	55 mm	83 mm	80 mm	28 mm
071415 60	60 mm	87 mm	86 mm	30 mm



1" EXTENSION DIN 3123, ISO 3316

ART.-NO. 0714158116

SPECIFICATION

- Drive: 1" square socket, pin detent
- Tip: 1" square head, pin detent

VARIANTS

Art.-no.	Length	Drive	Drive type	Tip size
0714158108	200 mm	1 inch	Internal square	1 inch
0714158116	400 mm	1 inch	Internal square	1 inch



1 INCH POWER EXTENSION WITH 1 INCH SQUARE DRIVE AND BALL LOCK

ART.-NO. 0714158607

APPLICATION

- Fits all conventional compressed air and electric drivers

VARIANTS

Art.-no.	Length	Drive	Tip size	Socket wrench external diameter
0714158607	175 mm	1 inch	1 inch	54 mm
071415201	300 mm	1 inch	1 inch	54 mm

POWER + HAND TOOLS

HAND TOOLS



RATCHET WRENCH SET MINI LIMITED EDITION

ART.-NO. 07142019

APPLICATION

- 31 pieces. Equipped with the most popular short socket wrench inserts, ratchet wrenches and bits. Specially designed for use in the tightest of spaces. Würth will donate 1 euro to a charitable organisation from the proceeds of each set sold.



METRIC DOUBLE BOX-END WRENCH HEXAGON WITH POWERDRIV®

ART.-NO. 0714240080

APPLICATION

- Tightening and loosening union nuts and pipe screw joints



DOUBLE-JOINTED SOCKET WRENCH

ART.-NO. 0714244168

APPLICATION

- For use in tight spaces and around projecting edges.

VARIANTS

Art.-no.	Width across flats	Length	Handle width	Handle thickness
0714244089	8 x 9 mm	175 mm	10.5 mm	5 mm
0714244101	10 x 11 mm	197 mm	12 mm	5.5 mm
0714244123	12 x 13 mm	213 mm	14 mm	5.5 mm
0714244145	14 x 15 mm	232 mm	15.5 mm	6.5 mm
0714244168	16 x 18 mm	272 mm	18 mm	8 mm
0714244179	17 x 19 mm	274 mm	18 mm	8 mm

V



METRIC RATCHET COMBINATION WRENCH WITH POWERDRIV®

ART.-NO. 071425109

APPLICATION

- The ratchet on the straight box end is used for tightening the most common screw types

VARIANTS

Art.-no.	Width across flats	Length	Thickness of jaw	Ring thickness
071425109	9 mm	149 mm	7 mm	4.8 mm
071425110	10 mm	159 mm	7.3 mm	5.3 mm
071425111	11 mm	165 mm	7.7 mm	5.8 mm
071425112	12 mm	171 mm	8.3 mm	6.4 mm
071425113	13 mm	178 mm	8.6 mm	6.6 mm
071425114	14 mm	190 mm	9 mm	6.1 mm
071425115	15 mm	199 mm	9.5 mm	6.4 mm
071425116	16 mm	208 mm	10 mm	6.7 mm
071425117	17 mm	225 mm	10.3 mm	8.1 mm
071425118	18 mm	236 mm	10.7 mm	8.4 mm
071425119	19 mm	248 mm	11.2 mm	8.7 mm
071425121	21 mm	289 mm	13 mm	9 mm
071425127	27 mm	358 mm	10.5 mm	15.5 mm
071425130	30 mm	401 mm	11.4 mm	17 mm
071425132	32 mm	424 mm	12.5 mm	17.5 mm



RATCHET COMBINATION WRENCH SET, METRIC, STRAIGHT 5 PIECES IN PLASTIC CASE

ART.-NO. 0714251100

APPLICATION

- With extremely narrow ring side for working in compact spaces



PULLER, TRIPLE LEG, DOUBLE HOOK

ART.-NO. 0714251100

APPLICATION

- Reversible wide or narrow hook ends clamp automatically.

QUALITY WITH OUR HAND TOOLS

POWER + HAND TOOLS

HAND TOOLS



EXTERNAL PULLER, TRIPLE LEG, ADJUSTABLE

ART.-NO. 0714523202

APPLICATION

- Suitable for removing races and gears mounted on longer shafts

VARIANTS

Art.-no.	External clamping width	Clamping depth	Spindle length	Hook-tip length
0714523132	130 mm	140 mm	140 mm	11 mm
0714523202	200 mm	210 mm	200 mm	16 mm
0714523252	250 mm	260 mm	250 mm	18 mm



SEPARATOR

ART.-NO. 0714524075

APPLICATION

- For separating stuck or thin races and gears

VARIANTS

Art.-no.	Min./max. internal clamping width	Width of clamping jaw	Spindle length	Min./max. hole distance
0714524075	14-75 mm	115 mm	170 mm	76-139 mm
0714524115	22-115 mm	170 mm	250 mm	115-208 mm



PULLER TOOL

ART.-NO. 0714524200

APPLICATION

- After separating, the legs of the puller tool are screwed into the separating blade and the cross-beam is mounted. The spindle is screwed against the shaft. The part being extracted is pulled off gently and securely by tightening the spindle against the end of the shaft.

VARIANTS

Art.-no.	Min./max. external clamping width	Clamping depth	Spindle length	Width across flats
0714524200	70-215 mm	250 mm	210 mm	22 mm
0714524300	90-300 mm	270 mm	280 mm	27 mm



PIPE CUTTER

ART.-NO. 0714551331

APPLICATION

- Easy cutting of aluminium, copper and thin-walled metal pipes

VARIANTS

Art.-no.	Min./max. external clamping width	Clamping depth	Spindle length	Width across flats
0714524200	70-215 mm	250 mm	210 mm	22 mm
0714524300	90-300 mm	270 mm	280 mm	27 mm



OIL FILTER WRENCH THREE ARMS

ART.-NO. 071457 10

APPLICATION

- Oil filter wrench



OIL FILTER WRENCH, SPARE BELT

ART.-NO. 071457 13

APPLICATION

- Oil filter wrench, spare belt



SPRING BAND CLAMP PLIERS

ART.-NO. 0714577111

APPLICATION

- Rotating clamping jaws enable universal alignment of the clamp in tight spaces.
- The locking mechanism holds the clamp in the open position without the application of force.
- Special safety jaws prevent the tensioned clamps from sliding out.
- Extra long design for convenient pre-tensioning of clamps
- Special steel construction with PVC handle casing

POWER + HAND TOOLS

HAND TOOLS



CRIMP PLIERS FOR SCREWLESS HOSE CLAMPS

ART.-NO. 0714577117

APPLICATION

- Hose clamp pliers, screwless



VACUUM LIFTER WITH TWO MOVABLE HEADS

ART.-NO. 071458 20

APPLICATION

- For transporting curved windscreens such as e.g. vehicle windscreens



WINDSCREEN REMOVAL ASSORTMENT 5 PIECES

ART.-NO. 071458 25

APPLICATION

- To easily detach washers.



ROUND CUTTING WIRE

ART.-NO. 071458 28

APPLICATION

- Braided for high cutting capacity despite lack of cutting edges

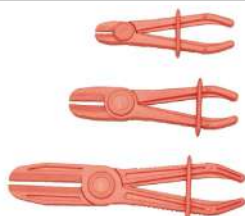

HOSE PINCH-OFF PLIERS SET FOR FLEXIBLE HOSES AND LINES WITHOUT METAL FABRIC

ART.-NO. 0714601931

APPLICATION

- For quick pinching off of water hoses, oil and fuel lines
- Locking mechanism holds the pliers in the desired clamping position
- Rounded clamping jaws prevent unintentional damage to lines
- Fibreglass reinforced plastic construction in striking red signal colour



PINCH-OFF PLIERS FOR FLEXIBLE HOSES AND LINES WITHOUT METAL FABRIC

ART.-NO. 0714601956

APPLICATION

- For quick pinching off of water hoses, oil and fuel lines
- Locking mechanism holds the pliers in the desired clamping position
- Rounded clamping jaws prevent unintentional damage to lines
- Fibreglass reinforced plastic construction in striking red signal colour



FLAT BLUNT-ENDED FILE DIN 7261, SHAPE A

ART.-NO. 071461 12

APPLICATION

- Ideal geometry of file cut (ideal cut angle, uniform tooth height and spacing)

VARIANTS

Art.-no.	File cut	File blade length	Width	Thickness
071461 02	1	250 mm	25 mm	6.3 mm
071461 12	3	250 mm	25 mm	6.3 mm



TRIANGULAR FILE DIN 7261, SHAPE C

ART.-NO. 071461 21

APPLICATION

- Ideal geometry of file cut (ideal cut angle, uniform tooth height and spacing)

POWER + HAND TOOLS

POWER TOOLS



CORDLESS SCREWDRIVER S 3-A

ART.-NO. 07001022

APPLICATION

- Handy and compact cordless unit with two speeds for screwing and drilling.



CORDLESS ANGLE GRINDER EWS 28-A

ART.-NO. 070023704

APPLICATION

- Powerful battery-powered angle grinder with lithium-ion technology. Battery capacity can be selected freely thanks to PICK YOUR POWER.



DRY VACUUM CLEANER TSS 7-L BASIC

ART.-NO. 07011170

APPLICATION

- Compact, lightweight dry vacuum cleaner with ergonomic carry strap



INDUSTRIAL WET AND DRY VACUUM CLEANER ISS 30-L

ART.-NO. 07011320

APPLICATION

- Handy and ergonomic universal vacuum with L-certification and semi-automatic filter cleaning



INDUSTRIAL WET AND DRY VACUUM CLEANER ISS 30-L AUTOMATIC

ART.-NO. 07011330

APPLICATION

- Universal vacuum cleaner with L certification and automatic filter cleaning



HIGH-PRESSURE CLEANER HDR 160 COMPACT

ART.-NO. 07011610

APPLICATION

- Compact cold water high-pressure cleaner for medium-duty cleaning jobs



POWER + HAND TOOLS

POWER TOOLS



DRY WALLING SCREWDRIVER S 50 TB

ART.-NO. 07020500

APPLICATION

- Extremely light and handy dry construction driver



DRILL BM 10-E COMPACT

ART.-NO. 07023270

APPLICATION

- Compact, powerful drill for fast, powerful drilling in wood, aluminium, metal and stainless steel



TWO-HAND ANGLE GRINDER EWS 24-180-S

ART.-NO. 070244520

APPLICATION

- 2400-watt angle grinder with quick-clamping nut, for discs with max. 180 mm diameter.



TWO-HAND ANGLE GRINDER EWS 24-230

ART.-NO. 070244610

APPLICATION

- 2400 W angle grinder for discs with max. 230 mm diameter



STRAIGHT GRINDER GSL 950-E POWER

ART.-NO. 07025220

APPLICATION

- The geared high-power model with long neck and planetary gear unit for machining surfaces



ELECTRIC IMPACT DRILL EDI 13-K

ART.-NO. 0702600001

APPLICATION

- Powerful, compact and lightweight impact drill with quick metal chuck up to 13mm. Fast drilling and long service life.

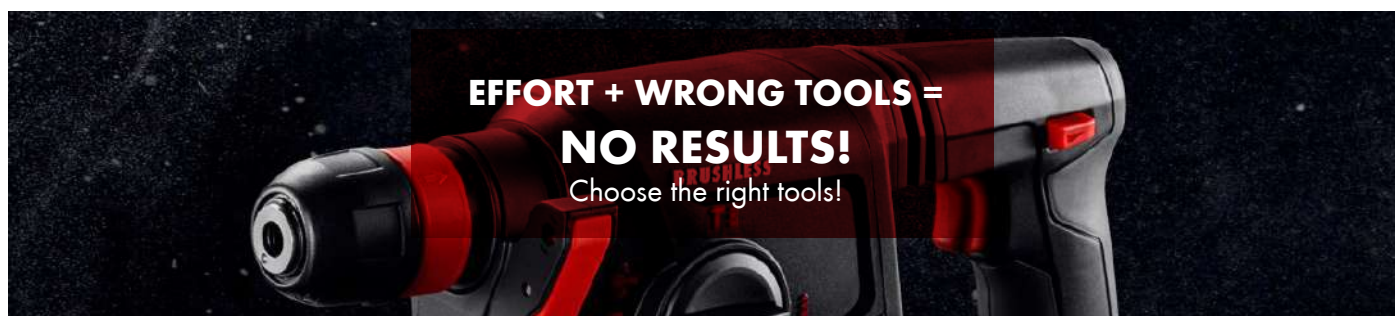

POWER + HAND TOOLS

POWER TOOLS



ELECTRIC ROTARY HAMMER DRILL ERHD 28-MLS

ART.-NO. 0702600002

APPLICATION

- Light hammer drill with outstanding impact strength of 3,2J for light drilling, hammering and chiselling in construction.



POLISHING MACHINE EPM 2000-7

ART.-NO. 0702600005

APPLICATION

- Designed for a wide range of polishing and sanding applications, and is ideal for automotive and marine detailing as well as stone polishing work (dry application only).



SABRE SAW SBS 1300

ART.-NO. 0702600007

APPLICATION

- 1,300 W powerful, precise sabre saw, developed for use in wood and metal.



ANGLE GRINDER EAG 24-230

ART.-NO. 0702600009

APPLICATION

- Extremely powerful 2400 W angle grinder for discs with max. 230 mm diameter



HAND-HELD CIRCULAR SAW ECS 1100

ART.-NO. 0702600010

APPLICATION

- 1100 Watt hand-held circular saw with cutting depth of 67 mm.



BRUSHLESS 18V CORDLESS IMPACT WRENCH

ART.-NO. 0702600022

APPLICATION

- Automotive: tire maintenance.
- Construction: general bolt tightening.
- Woodworking: roofing assembly on hard timber.



HOT GLUE GUN HKP 220

ART.-NO. 0702623

APPLICATION

- Especially powerful glue gun, ideal for all installation, repair, fixing and decoration work



VISUAL ANTI-FREEZE, BATTERY AND AD BLUE TESTER FOR RELIABLY TESTING RADIATOR ANTI-FREEZE, BATTERY ACID AND ADBLUE IN ONE UNIT

ART.-NO. 0704510

APPLICATION

- For reliable testing of radiator anti-freeze, battery acid and AD Blue in one unit

POWER + HAND TOOLS

HIGH POWER BATTERIES



ALKALINE BATTERY HIGH POWER - AAA

ART.-NO. 08271 11

APPLICATION

- Battery power for energy-intensive application

NOTICE

- Cannot be recharged



ALKALINE BATTERY HIGH POWER - AA

ART.-NO.08271 12

APPLICATION

- Battery power for energy-intensive application

NOTICE

- Cannot be recharged



ALKALINE BATTERY HIGH POWER - BABY C

ART.-NO.08271 13

APPLICATION

- Battery power for energy-intensive application

NOTICE

- Cannot be recharged



ALKALINE BATTERY HIGH POWER - MONO

ART.-NO.08271 14

APPLICATION

- Battery power for energy-intensive application

NOTICE

- Cannot be recharged



ALKALINE BATTERY HIGH POWER - E BLOCK

ART.-NO.08271 15

APPLICATION

- Battery power for energy-intensive application

NOTICE

- Cannot be recharged



HIGH CAPACITY AND LONG-LASTING PERFORMANCE



**PNEUMATIC
TOOLS**

**#READY
FOR WORK**

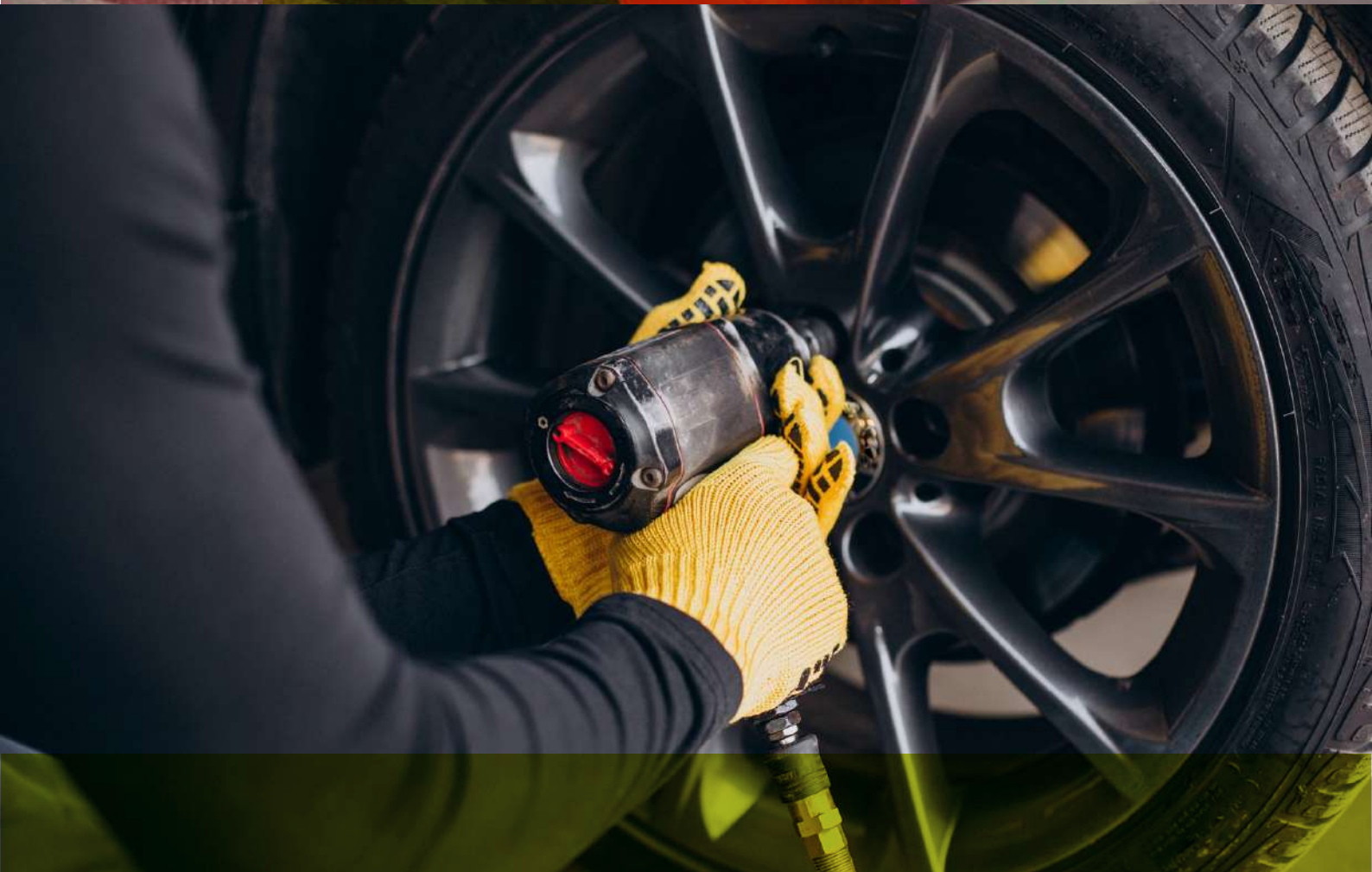

PNEUMATIC TOOLS



PNEUMATIC ROD GRINDER DSG 22 STANDARD

ART.-NO. 07032270

APPLICATION

- Ideal for a variety of applications, including porting, weld cleaning, deburring, polishing and grinding



PNEUMATIC DIE GRINDER DSG 25

ART.-NO. 07032300

APPLICATION

- Rod grinder developed specifically for the toughest applications (e.g. deburring work) with high power reserves.



PNEUMATIC IMPACT SCREWDRIVER DSS 3/8'' PLUS

ART.-NO. 07032300

APPLICATION

- Ideal for working on vehicle bodies, gears, brake and exhaust systems and engines.



PNEUMATIC BRUSH GRINDER DBS 3600

ART.-NO. 07033601

APPLICATION

- Particularly well suited for cleaning of weld beads, seams, metal surfaces, wood and plastics.
- Removal of blooming discoloration, cinder, rust, corrosion, dirt and oxide, layers, coatings, paint, old paintwork, synthetic resins, adhesives, gasket residue, cement and concrete residue.
- Structuring, strip deadening, preparing and roughing of surfaces.
- Light deburring jobs.
- Cleaning of vehicle undersides as well as other diversified work in car body shops.



PNEUMATIC STAPLE GUN DKG 416

ART.-NO. 07035480

APPLICATION

- Used on upholstered furniture, packaging, vapour barriers, vapour seals, insulation, cladding and in the furniture industry.



PNEUMATIC IMPACT SCREWDRIVER DSS 1/2 INCH H

ART.-NO. 07037360

APPLICATION

- Reliable, powerful impact screwdriver with fast build-up of torque



PNEUMATIC RANDOM OSCILLATING ORBITAL SANDER DTS 152C

ART.-NO. 07037521

APPLICATION

- For dry sanding wood, metal surfaces, bodywork, to remove layers of paint, rust, etc. With a 5-mm random orbital disc particularly suitable for roughing



PNEUMATIC ECCENTRIC ROTARY SANDER DTS 150S

ART.-NO. 07037531

APPLICATION

- Great for surface preparation from body filler to paint primer

PNEUMATIC TOOLS



PNEUMATIC IMPACT SCREWDRIVER DSS 1/2" STANDARD

ART.-NO. 07037560

APPLICATION

- Perfectly suitable for wheel changes on passenger cars.



PNEUMATIC IMPACT WRENCH KIT DSS 1/2" H

ART.-NO. 07037561

APPLICATION

- Pure power through the most challenging automotive (passenger cars) and jobsite tasks with a lightweight design that ensures the maximum comfort to the user. Recommended max. bolt size: M15



PNEUMATIC IMPACT SCREWDRIVER DSS 1 INCH L

ART.-NO. 07037700

APPLICATION

- Highly robust, powerful impact screwdriver with long square drive.



PNEUMATIC IMPACT SCREWDRIVER DSS 3/4 INCH H

ART.-NO. 07037730

APPLICATION

- Reliable, powerful impact screwdriver with fast build-up of torque



PNEUMATIC DRILL DBM 10-RL PLUS

ART.-NO. 07037960

APPLICATION

- Especially lightweight, handy drill with quick-action drill chuck. Right/left changeover with 10 mm drill chuck.



PNEUMATIC DRILL DBM 13-RL PLUS

ART.-NO. 07037970

APPLICATION

- Especially lightweight, handy drills with quick-action drill chuck. Right/left changeover with 13 mm drill chuck.



PNEUMATIC DRILL DBM 10-RL STANDARD

ART.-NO. 07037980

APPLICATION

- Great for all types of maintenance, general auto and truck work along with body shop work



PNEUMATIC RATCHET SCREWDRIVER DRS 1/2" PLUS

ART.-NO. 07038110

APPLICATION

- Durable ratchet driver with speed regulation and rubberized handle for the prevention of vibrations and cold hands.

PNEUMATIC TOOLS



PNEUMATIC RATCHET SCREWDRIVER DRS 3/8 INCH

ART.-NO. 07038380

APPLICATION

- Durable ratchet screwdriver with speed regulation and plastic handle to protect against vibrations and cold hands.



PNEUMATIC ANGLE GRINDER DWS 115 PLUS

ART.-NO. 07038550

APPLICATION

- Powerful, handy machine for sanding, cutting and roughing work.



PNEUMATIC POLISHING MACHINE DPM 250

ART.-NO. 0703000870

APPLICATION

- Perfect for weld smoothing, paint, rust and stone removal



PNEUMATIC RIVETER PNG 014

ART.-NO. 0703937014

APPLICATION

- Great for trailer panels, number plates, and any type of panels work

VI



**NOTHING
BUT MIGHTY &
PROFESSIONAL**

YOUR PARTNER IN QUALITY SOLUTIONS

READY TO EXPERIENCE WURTH ADVANTAGE?

NAIROBI BRANCH SHOP

+254 110 945 454
wuerth-nbi@wuerthkenya.co.ke

MOMBASA ROAD
ALPHA CENTER.

MOMBASA BRANCH SHOP

+254 721 590 750
wuerth-msa@wuerthkenya.co.ke

MERU ROAD OFF
DIGO ROAD.



SCAN ME TO VISIT
OUR E-SHOP

STAY CONNECTED ON
OUR OFFICIAL CHANNELS

    | @wuerthkenya

